

## SPLIT FERRITE CORE

## Kitagawa series: GRFC



- Cable tie feature on select lines.
- Harness guide provides easy harness winding.
- Prevents cable pinching.
- Suited for high frequency applications.
- Reduces labour time and cost.
- Typical applications include smart factories, air conditioning units, flat screen TVs and displays.

[Application Examples](#)
[Ferrite Selection Guide](#)
[RFC-H13/RFC-20](#)

**Material:** Ferrite Core: Soft ferrite

Housing: PA66 (Colour: light grey/Flammability: UL 94-V-0).

(Colour: black/Flammability: UL 94-V-2).

Part Number	Applicable cable diameter	A	B	C	D	Impedance $\Omega$ /100MHz (1 turn)
GRFC-3	$\varnothing 3.0 \sim 4.0$	13.7	13.5	18.0	-	$\geq 35$
GRFC-4	$\varnothing 3.5 \sim 4.5$	13.7	13.5	27.5	-	$\geq 75$
GRFC-5	$\varnothing 4.5 \sim 5.5$	18.1	18.4	31.5	35.5	$\geq 100$
GRFC-6	$\varnothing 5.5 \sim 6.5$	18.1	18.4	31.5	35.5	$\geq 100$
GRFC-7	Max $\varnothing 7$	14.25	15.8	20.0	24.0	$\geq 45$
GRFC-8	$\varnothing 7.5 \sim 8.5$	20.01	20.4	31.5	35.5	$\geq 75$
GRFC-9	$\varnothing 8.5 \sim 9.5$	20.01	20.4	31.5	35.5	$\geq 75$
GRFC-10	$\varnothing 9.5 \sim 10.5$	26.3	20.4	32.4	37.2	$\geq 105$
GRFC-13	$\varnothing 12.5 \sim 13.5$	29.1	20.4	31.5	36.3	$\geq 95$

Dimensions in mm.

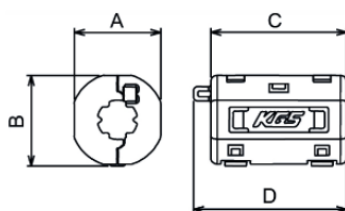

Part numbers GRFC-3, GRFC-4 and GRFC-7 have different configurations. Please contact sales team for engineering drawings.

